

DIMENSIONS OF CLASS 150 FLANGES

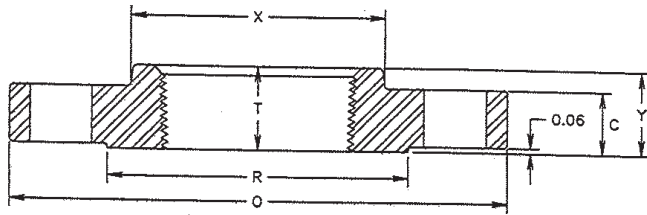

Threaded

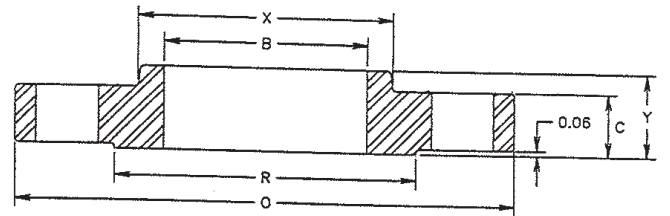

Slip-On Welding

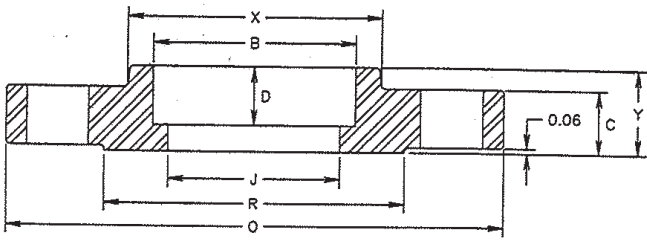

Socket Welding (B16 1/2" to 3" Only)

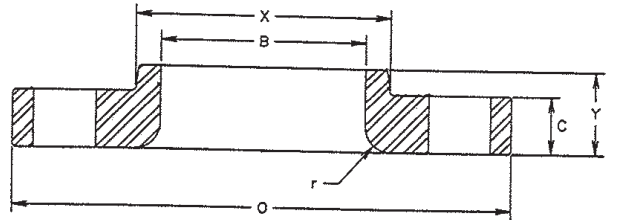

Lapped

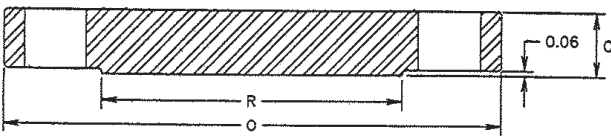

Blind

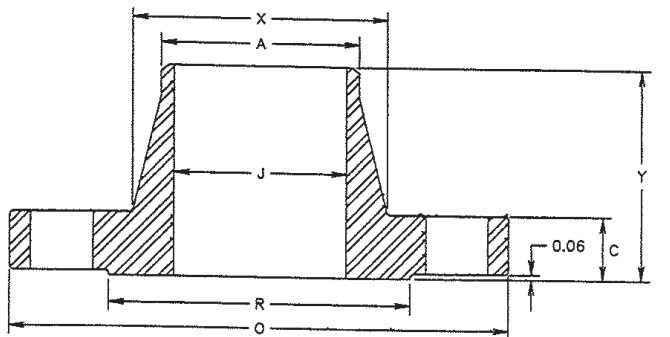

Welding Neck

### DIMENSIONS OF CLASS 150 FLANGES

GENERAL NOTE: Dimensions are in inches.

1	2	3	4	5	6	7			8	9	10	11		12	13	14	15	16		17	18
Nominal Pipe Size	Outside Diameter of Flange O	Thick- ness of Flange Min. C	Diameter of Raised Face R	Diameter of Hub at Base (Note 1.) X	Hub Diameter Begin- ning of Chamfer Welding Neck A	Length Through Hub			Thread Length Threaded Min. T	Bore			Corner Radius of Bore of Lapped Flange and Pipe r	Depth of Socket D	Drilling						
						Threaded Slip-On Socket Welding Y	Lapped Y	Welding Neck Y		Slip-On Socket Welding Min. B	Lapped Min. B	Welding Neck Socket Welding J			Diameter of Bolt Circle	Diameter of Bolt Holes	Number of Holes				
1/2	3.50	0.44	1.38	1.19	0.84	0.62	0.62	1.88	0.62	0.88	0.90		0.12	0.38	2.38	0.62	4				
3/4	3.88	0.50	1.69	1.50	1.05	0.62	0.62	2.06	0.62	1.09	1.11	S	0.12	0.44	2.75	0.62	4				
1	4.25	0.56	2.00	1.94	1.32	0.69	0.69	2.19	0.69	1.36	1.38	E	0.12	0.50	3.12	0.62	4				
1-1/4	4.62	0.62	2.50	2.31	1.66	0.81	0.81	2.25	0.81	1.70	1.72	E	0.19	0.56	3.50	0.62	4				
1-1/2	5.00	0.69	2.88	2.56	1.90	0.88	0.88	2.44	0.88	1.95	1.97		0.25	0.62	3.88	0.62	4				
2	6.00	0.75	3.62	3.06	2.38	1.00	1.00	2.50	1.00	2.44	2.46	B	0.31	0.69	4.75	0.75	4				
2-1/2	7.00	0.88	4.12	3.56	2.88	1.12	1.12	2.75	1.12	2.94	2.97	O	0.31	0.75	5.50	0.75	4				
3	7.50	0.94	5.00	4.25	3.50	1.19	1.19	2.75	1.19	3.57	3.60	R	0.38	0.81	6.00	0.75	4				
3-1/2	8.50	0.94	5.50	4.81	4.00	1.25	1.25	2.81	1.25	4.07	4.10	E	0.38	*0.88	7.00	0.75	8				
4	9.00	0.94	6.19	5.31	4.50	1.31	1.31	3.00	1.31	4.57	4.60		0.44	*0.94	7.50	0.75	8				
5	10.00	0.94	7.31	6.44	5.56	1.44	1.44	3.50	1.44	5.66	5.69	S	0.44	*0.94	8.50	0.88	8				
6	11.00	1.00	8.50	7.56	6.63	1.56	1.56	3.50	1.56	6.72	6.75	C	0.50	*1.06	9.50	0.88	8				
8	13.50	1.12	10.62	9.69	8.63	1.75	1.75	4.00	1.75	8.72	8.75	H	0.50	*1.25	11.75	0.88	8				
10	16.00	1.19	12.75	12.00	10.75	1.94	1.94	4.00	1.94	10.88	10.92	E	0.50	*1.31	14.25	1.00	12				
12	19.00	1.25	15.00	14.38	12.75	2.19	2.19	4.50	2.19	12.88	12.92	D	0.50	*1.56	17.00	1.00	12				
14	21.00	1.38	16.25	15.75	14.00	2.25	3.12	5.00	2.25	14.14	14.18	U	0.50	*1.62	18.75	1.12	12				
16	23.50	1.44	18.50	18.00	16.00	2.50	3.44	5.00	2.50	16.16	16.19	L	0.50	*1.75	21.25	1.12	16				
18	25.00	1.56	21.00	19.88	18.00	2.69	3.81	5.50	2.69	18.18	18.20	E	0.50	*1.94	22.75	1.25	16				
20	27.50	1.69	23.00	22.00	20.00	2.88	4.06	5.69	2.88	20.20	20.25	S	0.50	*2.12	25.00	1.25	20				
24	32.00	1.88	27.25	26.12	24.00	3.25	4.38	6.00	3.25	24.25	24.25		0.50	*2.50	29.50	1.38	20				

- Notes:
1. This dimension is for the base end of the hub, which may be straight or tapered. Taper shall not exceed 7° on threaded, slip-on, socket-welding, and lapped flanges.
  2. Lap Joints (14" +) made with Slip-On Welding length through hub are nonstandard.
  3. Blind flanges may be made with or without hubs. Hubs are nonstandard.
  4. The flange dimensions illustrated are for .06 in. raised face (except lapped); for requirements of other facings, see the table on facings.
  5. For welding end and bevel, see the figure on welding end contours.
  6. When these flanges are required with flat face, either the full thickness or thickness with raised face removed may be furnished. Removing the raised face may make the length through the hub nonstandard.
  7. For thread of flange, see tables on threads.
  8. Socket welding flanges larger than NPS 3 in. are marked with a (\*), and are not B16 standard flanges.
  9. The raised face shall have a finish from 125 μ in. to 250 μ in. roughness.



**150 LB**

DIMENSIONS OF CLASS 300 FLANGES

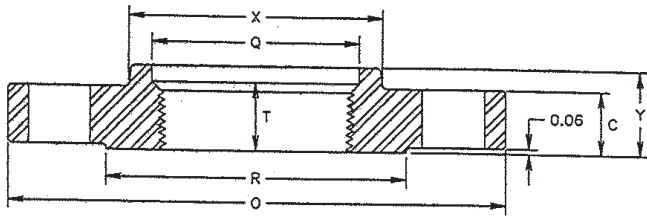

Threaded

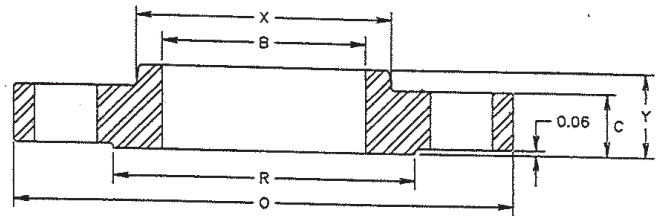

Slip-On Welding

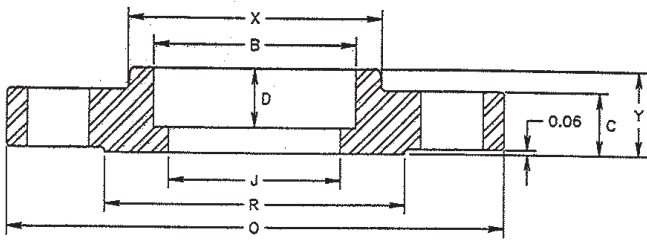

Socket Welding (B16 1/2" to 3" Only)

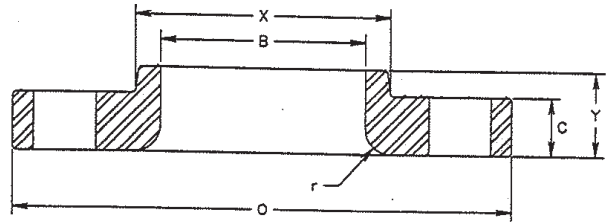

Lapped

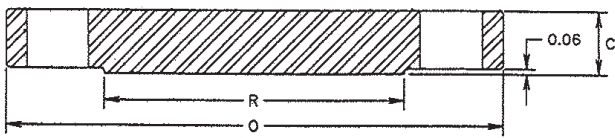

Blind

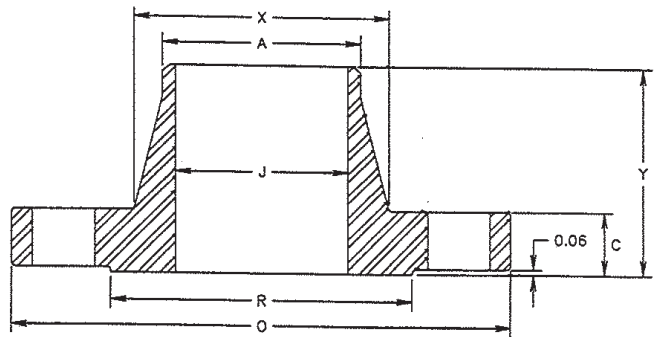

Welding Neck

### DIMENSIONS OF CLASS 300 FLANGES

GENERAL NOTE: Dimensions are in inches.

1	2	3	4	5	6	7	8	9	10	11	12	13	14	15	16	17	18	19
Nominal Pipe Size	Outside Diameter of Flange O	Thick- ness of Flange Min. C	Diameter of Raised Face R	Diameter of Hub at Base (Note 1.) X	Hub Diameter Begin- ning of Chamfer Welding Neck A	Length Through Hub			Thread Length Threaded Min. T	Bore			Corner Radius of Bore of Lapped Flange and Pipe r	Counter- bore Threaded Flange Min. Q	Depth of Socket D	Drilling		
						Threaded Slip-On Socket Welding Y	Lapped Y	Welding Neck Y		Slip-On Socket Welding Min. B	Lapped Min. B	Welding Neck Socket Welding J				Diameter of Bolt Circle	Diameter of Bolt Holes	Number of Holes
1/2	3.75	0.56	1.38	1.50	0.84	0.88	0.88	2.06	0.62	0.88	0.90		0.12	0.93	0.38	2.62	0.62	4
3/4	4.62	0.62	1.69	1.88	1.05	1.00	1.00	2.25	0.62	1.09	1.11	S	0.12	1.14	0.44	3.25	0.75	4
1	4.88	0.69	2.00	2.12	1.32	1.06	1.06	2.44	0.69	1.36	1.38	E	0.12	1.41	0.50	3.50	0.75	4
1-1/4	5.25	0.75	2.50	2.50	1.66	1.06	1.06	2.56	0.81	1.70	1.72	E	0.19	1.75	0.56	3.88	0.75	4
1-1/2	6.12	0.81	2.88	2.75	1.90	1.19	1.19	2.69	0.88	1.95	1.97		0.25	1.98	0.62	4.50	0.88	4
2	6.50	0.88	3.62	3.31	2.38	1.31	1.31	2.75	1.12	2.44	2.46	B	0.31	2.50	0.69	5.00	0.75	8
2-1/2	7.50	1.00	4.12	3.94	2.88	1.50	1.50	3.00	1.25	2.94	2.97	O	0.31	3.00	0.75	5.88	0.88	8
3	8.25	1.12	5.00	4.62	3.50	1.69	1.69	3.12	1.25	3.57	3.60	R	0.38	3.63	0.81	6.62	0.88	8
3-1/2	9.00	1.19	5.50	5.25	4.00	1.75	1.75	3.19	1.44	4.07	4.10	E	0.38	4.13	*0.88	7.25	0.88	8
4	10.00	1.25	6.19	5.75	4.50	1.88	1.88	3.38	1.44	4.57	4.60		0.44	4.63	*0.94	7.88	0.88	8
5	11.00	1.38	7.31	7.00	5.56	2.00	2.00	3.88	1.69	5.66	5.69	S	0.44	5.69	*0.94	9.25	0.88	8
6	12.50	1.44	8.50	8.12	6.63	2.06	2.06	3.88	1.81	6.72	6.75	C	0.50	6.75	*1.06	10.62	0.88	12
8	15.00	1.62	10.62	10.25	8.63	2.44	2.44	4.38	2.00	8.72	8.75	H	0.50	8.75	*1.25	13.00	1.00	12
10	17.50	1.88	12.75	12.62	10.75	2.62	3.75	4.62	2.19	10.88	10.92	E	0.50	10.88	*1.31	15.25	1.12	16
12	20.50	2.00	15.00	14.75	12.75	2.88	4.00	5.12	2.38	12.88	12.92	D	0.50	12.94	*1.56	17.75	1.25	16
14	23.00	2.12	16.25	16.75	14.00	3.00	4.38	5.62	2.50	14.14	14.18	U	0.50	14.19	*1.62	20.25	1.25	20
16	25.50	2.25	18.50	19.00	16.00	3.25	4.75	5.75	2.69	16.16	16.19	L	0.50	16.19	*1.75	22.50	1.38	20
18	28.00	2.38	21.00	21.00	18.00	3.50	5.12	6.25	2.75	18.18	18.20	E	0.50	18.19	*1.94	24.75	1.38	24
20	30.50	2.50	23.00	23.12	20.00	3.75	5.50	6.38	2.88	20.20	20.25	S	0.50	20.19	*2.12	27.00	1.38	24
24	36.00	2.75	27.25	27.62	24.00	4.19	6.00	6.62	3.25	24.25	24.25		0.50	24.19	*2.50	32.00	1.62	24

- Notes:
1. This dimension is for the base end of the hub, which may be straight or tapered. Taper shall not exceed 7° on threaded, slip-on, socket-welding, and lapped flanges.
  2. Lap Joints (10" +) made with Slip-On Welding length through hub are nonstandard.
  3. Blind flanges may be made with or without hubs. Hubs are nonstandard.
  4. The flange dimensions illustrated are for .06 in. raised face (except lapped); for requirements of other facings, see the table on facings.
  5. For welding end and bevel, see the figure on welding end contours.
  6. When these flanges are required with flat face, either the full thickness or thickness with raised face removed may be furnished. Removing the raised face may make the length through the hub nonstandard.
  7. For thread of flange, see tables on threads.
  8. Socket welding flanges larger than NPS 3 in. are marked with a (\*), and are not B16 standard flanges.
  9. The raised face shall have a finish from 125 μ in. to 250 μ in. roughness



**300 LB.**

DIMENSIONS OF CLASS 600 FLANGES

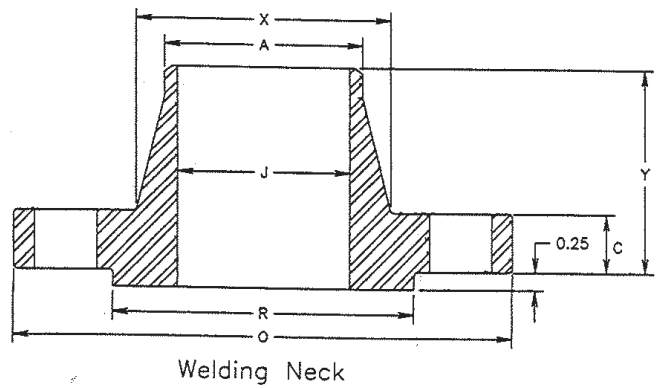
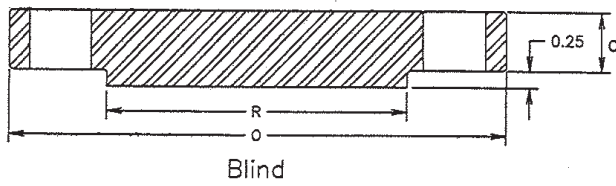
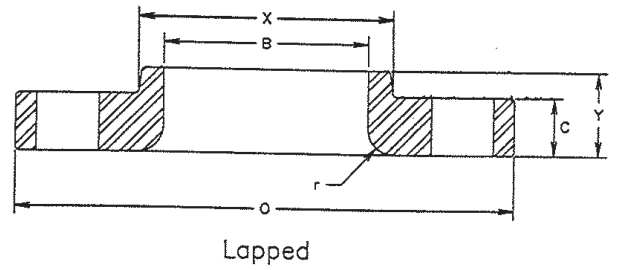
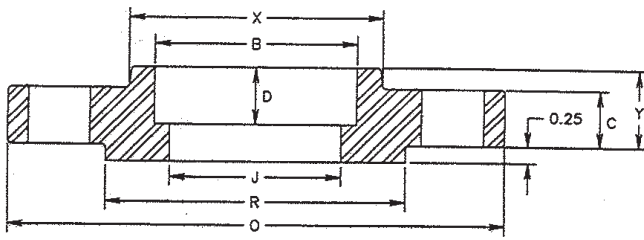
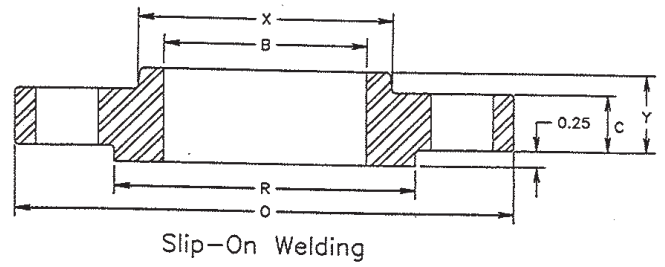
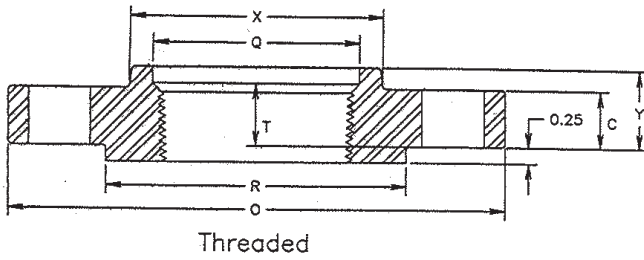

### DIMENSIONS OF CLASS 600 FLANGES

GENERAL NOTE: Dimensions are in inches.

1	2	3	4	5	6	7	8	9	10	11	12	13	14	15	16	17	18	19
Nominal Pipe Size	Outside Diameter of Flange O	Thick-ness of Flange Min. C	Diameter of Raised Face R	Diameter of Hub at Base (Note 1.) X	Hub Diameter Begin-ning of Chamfer Welding Neck A	Length Through Hub			Thread Length Threaded Min. T	Bore			Corner Radius of Bore of Lapped Flange and Pipe r	Counter-bore Threaded Flange Min. Q	Depth of Socket D	Drilling		
						Threaded Slip-On Socket Welding Y	Lapped Y	Welding Neck Y		Slip-On Socket Welding Min. B	Lapped Min. B	Welding Neck Socket Welding J				Diameter of Bolt Circle	Diameter of Bolt Holes	Number of Holes
1/2	3.75	0.56	1.38	1.50	0.84	0.88	0.88	2.06	0.62	0.88	0.90		0.12	0.93	0.38	2.62	0.62	4
3/4	4.62	0.62	1.69	1.88	1.05	1.00	1.00	2.25	0.62	1.09	1.11	S	0.12	1.14	0.44	3.25	0.75	4
1	4.88	0.69	2.00	2.12	1.32	1.06	1.06	2.44	0.69	1.36	1.38	E	0.12	1.41	0.50	3.50	0.75	4
1-1/4	5.25	0.81	2.50	2.50	1.66	1.12	1.12	2.62	0.81	1.70	1.72	E	0.19	1.75	0.56	3.88	0.75	4
1-1/2	6.12	0.88	2.88	2.75	1.90	1.25	1.25	2.75	0.88	1.95	1.97		0.25	1.99	0.62	4.50	0.88	4
2	6.50	1.00	3.62	3.31	2.38	1.44	1.44	2.88	1.12	2.44	2.46	B	0.31	2.50	0.69	5.00	0.75	8
2-1/2	7.50	1.12	4.12	3.94	2.88	1.62	1.62	3.12	1.25	2.94	2.97	O	0.31	3.00	0.75	5.88	0.88	8
3	8.25	1.25	5.00	4.62	3.50	1.81	1.81	3.25	1.38	3.57	3.60	R	0.38	3.63	0.81	6.62	0.88	8
3-1/2	9.00	1.38	5.50	5.25	4.00	1.94	1.94	3.38	1.56	4.07	4.10	E	0.38	4.13	*0.88	7.25	1.00	8
4	10.75	1.50	6.19	6.00	4.50	2.12	2.12	4.00	1.62	4.57	4.60		0.44	4.63	*0.94	8.50	1.00	8
5	13.00	1.75	7.31	7.44	5.56	2.38	2.38	4.50	1.88	5.66	5.69	S	0.44	5.69	*0.94	10.50	1.12	8
6	14.00	1.88	8.50	8.75	6.63	2.62	2.62	4.62	2.00	6.72	6.75	C	0.50	6.75	*1.06	11.50	1.12	12
8	16.50	2.19	10.62	10.75	8.63	3.00	3.00	5.25	2.25	8.72	8.75	H	0.50	8.75	*1.25	13.75	1.25	12
10	20.00	2.50	12.75	13.50	10.75	3.38	4.38	6.00	2.56	10.88	10.92	E	0.50	10.88	*1.31	17.00	1.38	16
12	22.00	2.62	15.00	15.75	12.75	3.62	4.62	6.12	2.75	12.88	12.92	D	0.50	12.94	*1.56	19.25	1.38	20
14	23.75	2.75	16.25	17.00	14.00	3.69	5.00	6.50	2.88	14.14	14.18	U	0.50	14.19	*1.62	20.75	1.50	20
16	27.00	3.00	18.50	19.50	16.00	4.19	5.50	7.00	3.06	16.16	16.19	L	0.50	16.19	*1.75	23.75	1.62	20
18	29.25	3.25	21.00	21.50	18.00	4.62	6.00	7.25	3.12	18.18	18.20	E	0.50	18.19	*1.94	25.75	1.75	20
20	32.00	3.50	23.00	24.00	20.00	5.00	6.50	7.50	3.25	20.20	20.25	S	0.50	20.19	*2.12	28.50	1.75	24
24	37.00	4.00	27.25	28.25	24.00	5.50	7.25	8.00	3.62	24.25	24.25		0.50	24.19	*2.50	33.00	2.00	24

- Notes:
1. This dimension is for the base end of the hub, which may be straight or tapered. Taper shall not exceed 7° on threaded, slip-on, socket-welding, and lapped flanges.
  2. Lap Joints (10" +) made with Slip-On Welding length through hub are nonstandard.
  3. Blind flanges may be made with or without hubs. Hubs are nonstandard.
  4. The flange dimensions illustrated are for .25 in. raised face (except lapped); for requirements of other facings, see the table on facings.
  5. For welding end and bevel, see the figure on welding end contours.

6. For thread of flange, see tables on threads.
7. Socket welding flanges larger than NPS 3 in. are marked with a (\*), and are not B16 standard flanges.
8. The raised face shall have a finish from 125 μ in. to 250 μ in. roughness



**600 LB.**

DIMENSIONS OF CLASS 900 FLANGES

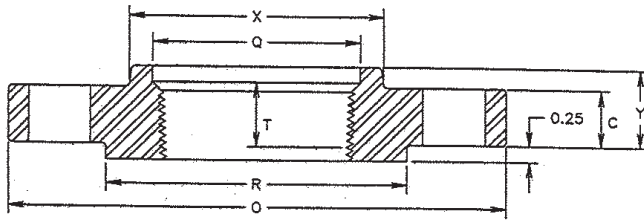

Threaded

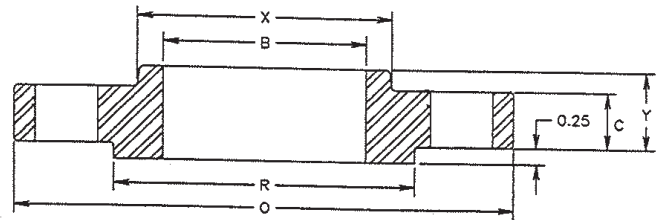

Slip-On Welding

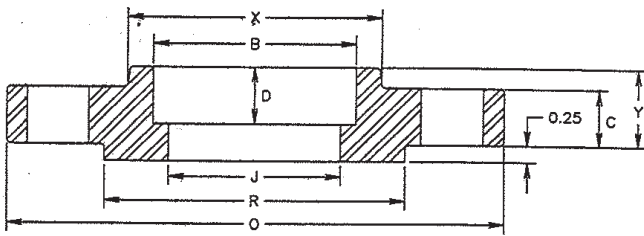

Socket Welding (B16 1/2" to 2 1/2" Only)

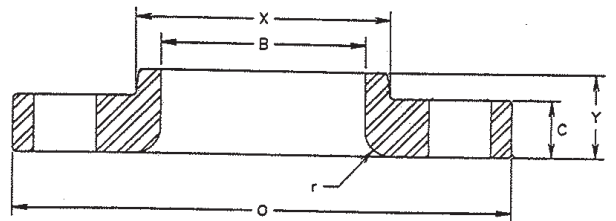

Lapped

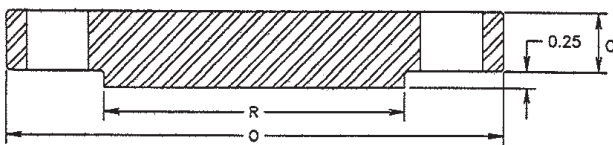

Blind

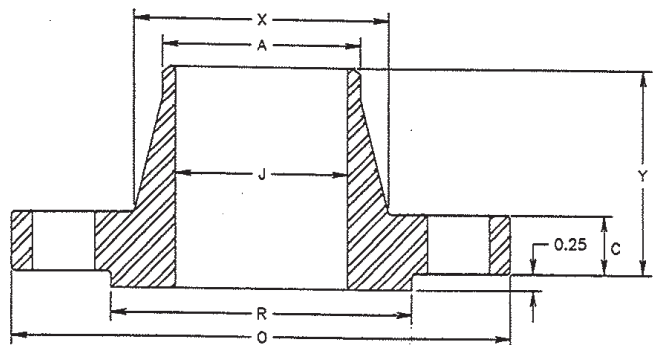

Welding Neck

### DIMENSIONS OF CLASS 900 FLANGES

GENERAL NOTE: Dimensions are in inches.

1	2	3	4	5	6	7 8 9			10	11 12 13			14	15	16	17	18	19
Nominal Pipe Size	Outside Diameter of Flange O	Thickness of Flange Min. C	Diameter of Raised Face R	Diameter of Hub at Base (Note 1.) X	Hub Diameter Beginning of Chamfer Welding Neck A	Length Through Hub			Thread Length Threaded Min. T	Bore			Corner Radius of Bore of Lapped Flange and Pipe r	Counter-bore Threaded Flange Min. Q	Depth of Socket D	Drilling		
						Threaded Slip-On Socket Welding Y	Lapped Y	Welding Neck Y		Slip-On Socket Welding Min. B	Lapped Min. B	Welding Neck Socket Welding J				Diameter of Bolt Circle	Diameter of Bolt Holes	Number of Holes
*1/2	4.75	0.88	1.38	1.50	0.84	1.25	1.25	2.38	0.88	0.88	0.90		0.12	0.93	0.38	3.25	0.88	4
*3/4	5.12	1.00	1.69	1.75	1.05	1.38	1.38	2.75	1.00	1.09	1.11	S	0.12	1.14	0.44	3.50	0.88	4
*1	5.88	1.12	2.00	2.06	1.32	1.62	1.62	2.88	1.12	1.36	1.38	E	0.12	1.41	0.50	4.00	1.00	4
*1-1/4	6.25	1.12	2.50	2.50	1.66	1.62	1.62	2.88	1.19	1.70	1.72	E	0.19	1.75	0.56	4.38	1.00	4
*1-1/2	7.00	1.25	2.88	2.75	1.90	1.75	1.75	3.25	1.25	1.95	1.97		0.25	1.99	0.62	4.88	1.12	4
*2	8.50	1.50	3.62	4.12	2.38	2.25	2.25	4.00	1.50	2.44	2.46	B	0.31	2.50	0.69	6.50	1.00	8
*2-1/2	9.62	1.62	4.12	4.88	2.88	2.50	2.50	4.12	1.88	2.94	2.97	O	0.31	3.00	0.75	7.50	1.12	8
3	9.50	1.50	5.00	5.00	3.50	2.12	2.12	4.00	1.62	3.57	3.60	R	0.38	3.63	*0.81	7.50	1.00	8
3-1/2	---	---	---	---	---	---	---	---	---	---	---	E	---	---	---	---	---	---
4	11.50	1.75	6.19	6.25	4.50	2.75	2.75	4.50	1.88	4.57	4.60		0.44	4.63	*0.94	9.25	1.25	8
5	13.75	2.00	7.31	7.50	5.56	3.12	3.12	5.00	2.12	5.66	5.69	S	0.44	5.69	*0.94	11.00	1.38	8
6	15.00	2.19	8.50	9.25	6.63	3.38	3.38	5.50	2.25	6.72	6.75	C	0.50	6.75	*1.06	12.50	1.25	12
8	18.50	2.50	10.62	11.75	8.63	4.00	4.50	6.38	2.50	8.72	8.75	H	0.50	8.75	*1.25	15.50	1.50	12
10	21.50	2.75	12.75	14.50	10.75	4.25	5.00	7.25	2.81	10.88	10.92	E	0.50	10.88	*1.31	18.50	1.50	16
12	24.00	3.12	15.00	16.50	12.75	4.62	5.62	7.88	3.00	12.88	12.92	D	0.50	12.94	*1.56	21.00	1.50	20
14	25.25	3.38	16.25	17.75	14.00	5.12	6.12	8.38	3.25	14.14	14.18	U	0.50	14.19	*1.62	22.00	1.62	20
16	27.75	3.50	18.50	20.00	16.00	5.25	6.50	8.50	3.38	16.16	16.19	L	0.50	16.19	*1.75	24.25	1.75	20
18	31.00	4.00	21.00	22.25	18.00	6.00	7.50	9.00	3.50	18.18	18.20	E	0.50	18.19	*1.94	27.00	2.00	20
20	33.75	4.25	23.00	24.50	20.00	6.25	8.25	9.75	3.62	20.20	20.25	S	0.50	20.19	*2.12	29.50	2.12	20
24	41.00	5.50	27.25	29.50	24.00	8.00	10.50	11.50	4.00	24.25	24.25		0.50	24.19	*2.50	35.50	2.62	20

- Notes:
1. This dimension is for the base end of the hub, which may be straight or tapered. Taper shall not exceed 7° on threaded, slip-on, socket-welding, and lapped flanges.
  2. Lap Joints (8" +) made with Slip-On Welding length through hub are nonstandard.
  3. Blind flanges may be made with or without hubs. Hubs are nonstandard.
  4. The flange dimensions illustrated are for .25 in. raised face (except lapped); for requirements of other facings, see the table on facings.
  5. For welding end and bevel, see the figure on welding end contours.
  6. For thread of flange, see tables on threads.
  7. Socket welding flanges larger than NPS 2 1/2 in. are marked with a (\*), and are not B16 standard flanges.
  8. Dimensions of 1/2" to 2 1/2" are the same as for 1500 lb. flanges.
  9. The raised face shall have a finish from 125 μ in. to 250 μ in. roughness.



**900 LB.**

DIMENSIONS OF CLASS 1500 FLANGES

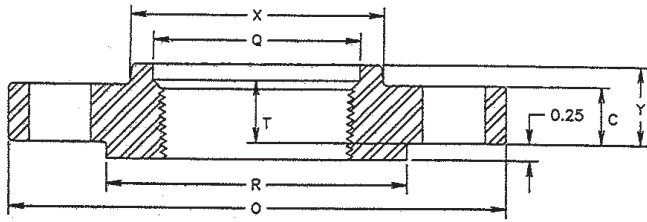

Threaded (B16 1/2" to 2 1/2" Only)

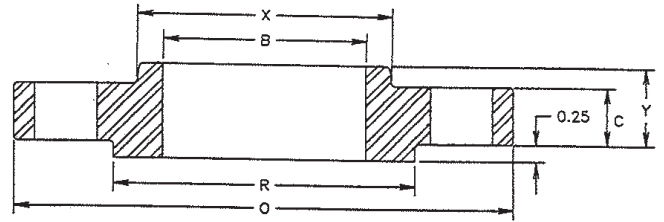

Slip-On Welding (B16 1/2" to 2 1/2" Only)

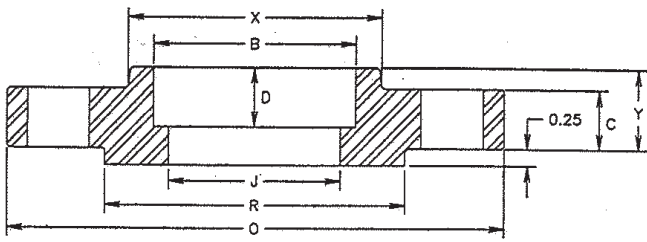

Socket Welding (B16 1/2" to 2 1/2" Only)

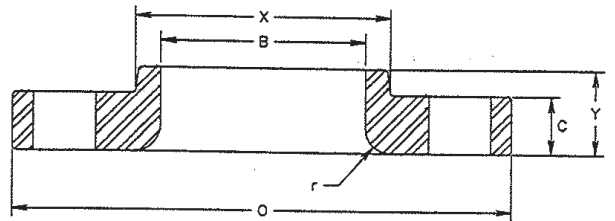

Lapped

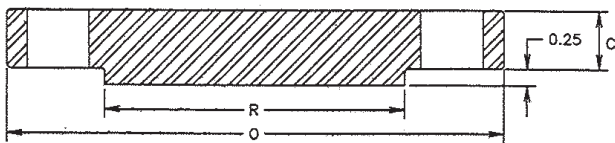

Blind

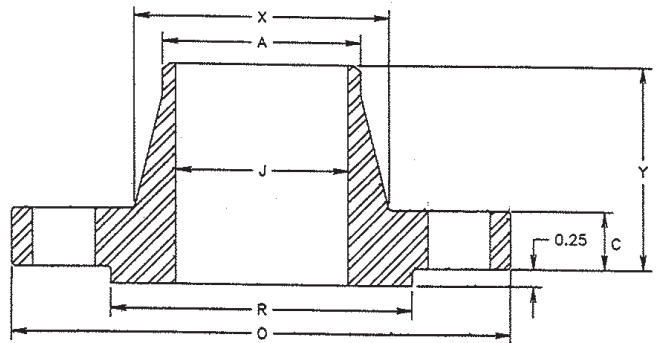

Welding Neck

### DIMENSIONS OF CLASS 1500 FLANGES

GENERAL NOTE: Dimensions are in inches.

1	2	3	4	5	6	7	8	9	10	11	12	13	14	15	16	17	18	19
Nominal Pipe Size	Outside Diameter of Flange O	Thick- ness of Flange Min. C	Diameter of Raised Face R	Diameter of Hub at Base (Note 1.) X	Hub Diameter Begin- ning of Chamfer Welding Neck A	Length Through Hub			Thread Length Threaded Min. T	Bore			Corner Radius of Bore of Lapped Flange and Pipe r	Counter- bore Threaded Flange Min. Q	Depth of Socket D	Drilling		
						Threaded Slip-On Socket Welding Y	Lapped Y	Welding Neck Y		Slip-On Socket Welding Min. B	Lapped Min. B	Welding Neck Socket Welding J				Diameter of Bolt Circle	Diameter of Bolt Holes	Number of Holes
1/2	4.75	0.88	1.38	1.50	0.84	1.25	1.25	2.38	0.88	0.88	0.90		0.12	0.93	0.38	3.25	0.88	4
3/4	5.12	1.00	1.69	1.75	1.05	1.38	1.38	2.75	1.00	1.09	1.11	S	0.12	1.14	0.44	3.50	0.88	4
1	5.88	1.12	2.00	2.06	1.32	1.62	1.62	2.88	1.12	1.36	1.38	E	0.12	1.41	0.50	4.00	1.00	4
1-1/4	6.25	1.12	2.50	2.50	1.66	1.62	1.62	2.88	1.19	1.70	1.72	E	0.19	1.75	0.56	4.38	1.00	4
1-1/2	7.00	1.25	2.88	2.75	1.90	1.75	1.75	3.25	1.25	1.95	1.97		0.25	1.99	0.62	4.88	1.12	4
2	8.50	1.50	3.62	4.12	2.38	2.25	2.25	4.00	1.50	2.44	2.46	B	0.31	2.50	0.69	6.50	1.00	8
2-1/2	9.62	1.62	4.12	4.88	2.88	2.50	2.50	4.12	1.88	2.94	2.97	O	0.31	3.00	0.75	7.50	1.12	8
3	10.50	1.88	5.00	5.25	3.50	*2.88	2.88	4.62	*2.00	3.57	3.60	R	0.38	*3.63	*0.81	8.00	1.25	8
3-1/2	---	---	---	---	---	---	---	---	---	---	---	E	---	---	---	---	---	---
4	12.25	2.12	6.19	6.38	4.50	*3.56	3.56	4.88	*2.25	4.57	4.60		0.44	*4.63	*0.94	9.50	1.38	8
5	14.75	2.88	7.31	7.75	5.56	*4.12	4.12	6.12	*2.50	5.66	5.69	S	0.44	*5.69	*0.94	11.50	1.62	8
6	15.50	3.25	8.50	9.00	6.63	*4.69	4.69	6.75	*2.75	6.72	6.75	C	0.50	*6.75	*1.06	12.50	1.50	12
8	19.00	3.62	10.62	11.50	8.63	*5.62	5.62	8.38	*3.00	8.72	8.75	H	0.50	*8.75	*1.25	15.50	1.75	12
10	23.00	4.25	12.75	14.50	10.75	*6.25	7.00	10.00	*3.31	10.88	10.92	E	0.50	*10.88	*1.31	19.00	2.00	12
12	26.50	4.88	15.00	17.75	12.75	*7.12	8.62	11.12	*3.62	12.88	12.92	D	0.50	*12.94	*1.56	22.50	2.12	16
14	29.50	5.25	16.25	19.50	14.00	---	9.50	11.75	---	14.14	14.18	U	0.50	*14.19	*1.62	25.00	2.38	16
16	32.50	5.75	18.50	21.75	16.00	---	10.25	12.25	---	16.16	16.19	L	0.50	*16.19	*1.75	27.75	2.62	16
18	36.00	6.38	21.00	23.50	18.00	---	10.88	12.88	---	18.18	18.20	E	0.50	*18.19	*1.94	30.50	2.88	16
20	38.75	7.00	23.00	25.25	20.00	---	11.50	14.00	---	20.20	20.25	S	0.50	*20.19	*2.12	32.75	3.12	16
24	46.00	8.00	27.25	30.00	24.00	---	13.00	16.00	---	24.25	24.25		0.50	*24.19	*2.50	39.00	3.62	16

- Notes:
1. This dimension is for the base end of the hub, which may be straight or tapered. Taper shall not exceed 7° on threaded, slip-on, socket-welding, and lapped flanges.
  2. Lap Joints (10" +) made with Slip-On Welding length through hub are nonstandard.
  3. Blind flanges may be made with or without hubs. Hubs are nonstandard.
  4. The flange dimensions illustrated are for .25 in. raised face (except lapped); for requirements of other facings, see the table on facings.
  5. For welding end and bevel, see the figure on welding end contours.
  6. For thread of flange, see tables on threads.
  7. Slip-On Welding, Threaded and Socket welding flanges larger than NPS 2 1/2 in. are marked with a (\*), and are not B16 standard flanges.
  8. The raised face shall have a finish from 125 μ in. to 250 μ in. roughness



**1500 LB.**

DIMENSIONS OF CLASS 2500 FLANGES

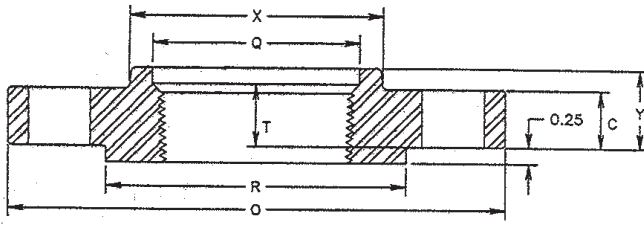

Threaded (B16 1/2" to 2 1/2" Only)

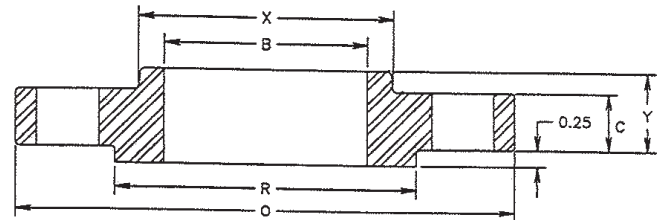

Slip-On Welding (B16 None)

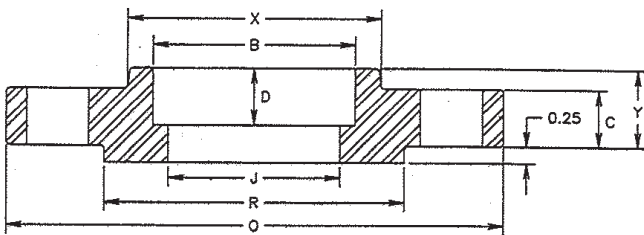

Socket Welding (B16 None)

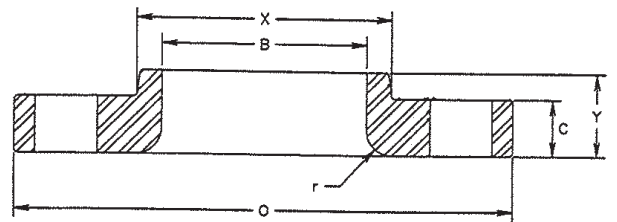

Lapped

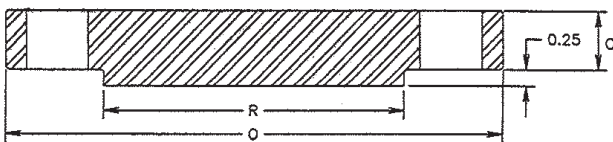

Blind

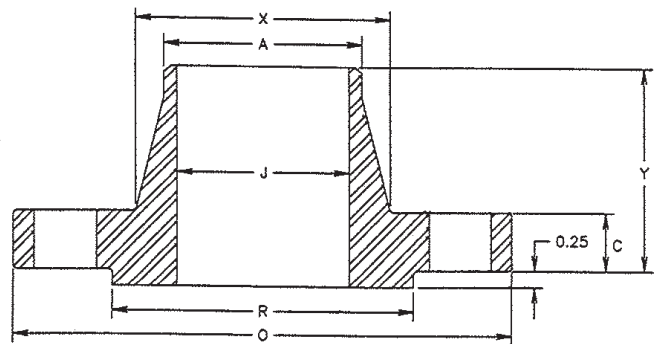

Welding Neck

## DIMENSIONS OF CLASS 2500 FLANGES

GENERAL NOTE: Dimensions are in inches.

1	2	3	4	5	6	7	8	9	10	11	12	13	14	15	16	17	18	19
Nominal Pipe Size	Outside Diameter of Flange O	Thick- ness of Flange Min. C	Diameter of Raised Face R	Diameter of Hub at Base (Note 1.) X	Hub Diameter Begin- ning of Chamfer Welding Neck A	Length Through Hub			Thread Length Threaded Min. T	Bore			Corner Radius of Bore of Lapped Flange and Pipe r	Counter- bore Threaded Flange Min. Q	Depth of Socket D	Drilling		
						Threaded Slip-On Socket Welding Y	Lapped Y	Welding Neck Y		Slip-On Socket Welding Min. B	Lapped Min. B	Welding Neck Socket Welding J				Diameter of Bolt Circle	Diameter of Bolt Holes	Number of Holes
1/2	5.25	1.19	1.38	1.69	0.84	1.56	1.56	2.88	1.12	*0.88	0.90		0.12	0.93	*0.38	3.50	0.88	4
3/4	5.50	1.25	1.69	2.00	1.05	1.69	1.69	3.12	1.25	*1.09	1.11	S	0.12	1.14	*0.44	3.75	0.88	4
1	6.25	1.38	2.00	2.25	1.32	1.88	1.88	3.50	1.38	*1.36	1.38	E	0.12	1.41	*0.50	4.25	1.00	4
1-1/4	7.25	1.50	2.50	2.88	1.66	2.06	2.06	3.75	1.50	*1.70	1.72	E	0.19	1.75	*0.56	5.12	1.12	4
1-1/2	8.00	1.75	2.88	3.12	1.90	2.38	2.38	4.38	1.75	*1.95	1.97		0.25	1.99	*0.62	5.75	1.25	4
2	9.25	2.00	3.62	3.75	2.38	2.75	2.75	5.00	2.00	*2.44	2.46	B	0.31	2.50	*0.69	6.75	1.12	8
2-1/2	10.50	2.25	4.12	4.50	2.88	3.12	3.12	5.62	2.25	*2.94	2.97	O	0.31	3.00	*0.75	7.75	1.25	8
3	12.00	2.62	5.00	5.25	3.50	*3.62	3.62	6.62	*2.50	*3.57	3.60	R	0.38	*3.63	*0.81	9.00	1.38	8
3-1/2	---	---	---	---	---	---	---	---	---	---	---	E	---	---	---	---	---	---
4	14.00	3.00	6.19	6.50	4.50	*4.25	4.25	7.50	*2.75	*4.57	4.60		0.44	*4.63	*0.94	10.75	1.62	8
5	16.50	3.62	7.31	8.00	5.56	*5.12	5.12	9.00	*3.00	*5.66	5.69	S	0.44	*5.69	*0.94	12.75	1.88	8
6	19.00	4.25	8.50	9.25	6.63	*6.00	6.00	10.75	*3.25	*6.72	6.75	C	0.50	*6.75	*1.06	14.50	2.12	8
8	21.75	5.00	10.62	12.00	8.63	*7.00	7.00	12.50	*3.75	*8.72	8.75	H	0.50	*8.75	*1.25	17.25	2.12	12
10	26.50	6.50	12.75	14.75	10.75	*9.00	9.00	16.50	*4.25	*10.88	10.92	E	0.50	*10.88	*1.31	21.25	2.62	12
12	30.00	7.25	15.00	17.38	12.75	*10.00	10.00	18.25	*4.75	*12.88	12.92	D	0.50	*12.94	*1.56	24.38	2.88	12
14	---	---	---	---	---	---	---	---	---	---	---	U	---	---	---	---	---	---
16	---	---	---	---	---	---	---	---	---	---	---	L	---	---	---	---	---	---
18	---	---	---	---	---	---	---	---	---	---	---	E	---	---	---	---	---	---
20	---	---	---	---	---	---	---	---	---	---	---	S	---	---	---	---	---	---
24	---	---	---	---	---	---	---	---	---	---	---		---	---	---	---	---	---

- Notes:
1. This dimension is for the base end of the hub, which may be straight or tapered. Taper shall not exceed 7° on threaded, slip-on, socket-welding, and lapped flanges.
  2. Blind flanges may be made with or without hubs. Hubs are nonstandard.
  3. The flange dimensions illustrated are for .25 in. raised face (except lapped); for requirements of other facings, see the table on facings.
  4. For welding end and bevel, see the figure on welding end contours.
  5. For thread of flange, see tables on threads.
  6. Threaded flanges larger than NPS 2 1/2 in. are marked with a (\*), and are not B16 standard flanges.
  7. 2500 lb. Slip-On Welding and Socket Welding flanges are not B16 standard flanges.
  8. The raised face shall have a finish from 125 μ in. to 250 μ in. roughness.



**2500 LB.**